

CORTECH

SYNC CHAIR

Lounge & Group Seating Chair

Versatile, spacious chair intended for lounging. The Sync Chair can stand alone or be combined with any Sync Series chair to create flexible arrangements that allow for change over time. The ergonomic design provides maximum comfort using rotational molding technology.

FEATURES:

- Lifetime warranty.
- 33H x 29W x 32D. **Seat Height:** 19".
- One piece, rotationally molded design for maximum durability. Made from high impact "no break" polyethylene.
- Integral plinth base for increased stability and floor mounting integrity.
- Can be bolted together in place, or to the floor via concealed pilot holes.
- 1500 lb. Static Load, ANSI/BIFMA X5.1-2011.
- Optional ballast doors to add weight with sandbags and secured with tamper-resistant screws.
 - (Do not use loose sand)**
- Sound dampening, easy to clean, sanitize, and maintain.
- ISO 22196 tested showing a >99% reduction in bacteria.
- Passes Flammability UL 94 HB.
- Flame Retardant: passes Cal 133. (Test reports available upon request)
- **Customization:** Custom colors available upon request. Contact Cortech for details.
- Manufactured in the USA to ISO Quality Standards. 

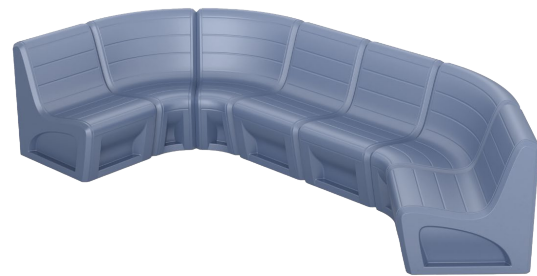

ITEM	COLOR
270AQ	Aqua
270BK	Black
270BG	Blue Gray
270BN	Brown
270BY	Burgundy
270GY	Gray
270GN	Green
270IG	Indigo
270MB	Midnight Blue
270SD	Sand
270SB	Slate Blue
270SG	Stone Gray

ITEM	COLOR
270AQS	Aqua with Access Door
270BKS	Black with Access Door
270BGS	Blue Gray with Access Door
270BNS	Brown with Access Door
270BYS	Burgundy with Access Door
270GYS	Gray with Access Door
270GNS	Green with Access Door
270IGS	Indigo with Access Door
270MBS	Midnight Blue with Access Door
270SDS	Sand with Access Door
270SBS	Slate Blue with Access Door
270SGS	Stone Gray with Access Door



Available in



Our Intense Use Products Contribute to a Safe and Humane Environment.

For Full Specifications Call Toll Free 800-571-0770 / Fax: 630-455-0813 / or Visit www.cortechusa.com

OVERVIEW

The Sync Chair is a versatile, spacious chair intended for lounging, with the ability to stand alone or be bolted together with any Endurance™ Sync Chair. The ergonomic design provides maximum comfort using rotational molding technology. **Manufactured to ISO Quality Standards in the USA.**

FABRICATION/MATERIAL

Durable, one piece, rotationally molded design for increased strength. Constructed with high impact “no break” polyethylene. Flame Retardant (as shown passes Cal 133). Test reports available upon request.

COLOR Aqua, Black, Blue Gray, Brown, Burgundy, Gray, Green, Indigo, Midnight Blue, Sand, Slate Blue, Stone Gray

WEIGHT 38 lbs.

OPTIONS Can be bolted to the floor via concealed pilot holes OR filled with sandbags through optional ballast door on site to weigh down. Hardware bit size: T27.

WARRANTY Lifetime Warranty.

MAINTENANCE Easy to clean, sanitize & maintain.

STATIC LOAD +1000 lbs.

